

Part Num.	Item Description	UPC# 046224 +	Ctn Qty	Ctn Wt	Line Art
-----------	------------------	---------------	---------	--------	----------

SPECIFICATION DRAWINGS ~ COMMERCIAL ITEMS

Catalog No.	Dimensions				
	A	B	C	D	E
5700PC	2 ³ / ₁₆ "	1 ⁷ / ₁₆ "	1"	7 ³ / ₄ "	5"

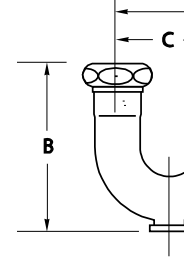
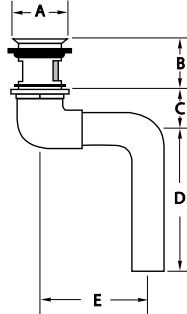
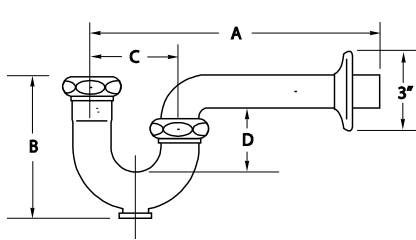

Catalog No.	Dimensions			
	A	B	C	D
5303	11"	5 ¹ / ₈ "	2 ¹ / ₂ "	1 ³ / ₄ "
5307-5311	12"	5 ¹ / ₄ "	2 ⁷ / ₈ "	2 ¹ / ₈ "

Catalog No.	Dimensions			
	A	B	C	D
5680PC	2 ³ / ₁₆ "	1 ¹ / ₂ "	4"	6 ³ / ₄ "
5682PC	2 ³ / ₁₆ "	1 ¹ / ₂ "	5 ³ / ₄ "	8 ¹ / ₄ "

- THE "COMMERCIAL LINE" MEANS QUALITY FOR PLUMBING PROFESSIONALS

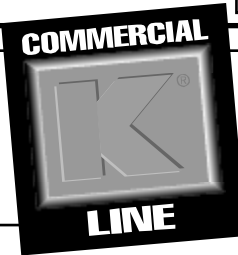

- SEMI CAST PRODUCTS
- LOOSE KEY STOPS

COMMERCIAL LINE

CROSS REFERENCE

KEENEY CAT. NO.	Am. Std. Cat. No.	Crane Cat. No.	Eljer Cat. No.	Kohler Cat. No.	Mc Guire Cat. No.
5303PC	4401.014	8-5260	804-1180	K-8998	8872
5311PC	4402.012	8-5260	804-1185	K-8999	8902
5307PC	4403.010	8-5260	804-1190	K-9000	8912
5459XPC	4418.026	8-5272	804-1100	K-9004	8088
5463XPC	4420.030	8-5272	804-1105	K-8995	8090
5461XPC	4419.040	8-5272	804-1110	K-8996	8089
384PC	4429.015	8-5270	804-1125	K-9010	201
385PC	4430.013	8-5270	804-1130	K-9010	202
5680PC	2411.015	8-5222	803-0552	K-7715	155-A
5700PC	7723.018		803-0530	K-13885	155-WC

SEMI-CAST TRAPS WITH CLEANOUT - BRASS NUTS

5303PC	1 1/4" X 1 1/4" 17GA POLISHED CHROME	SA	93263 5	25	38 lbs.
5311PC	1 1/4" X 1 1/2" 17GA POLISHED CHROME		93274 1	25	59 lbs.
5307PC	1 1/2" X 1 1/2" 17GA POLISHED CHROME	SA	93272 7	25	58 lbs.

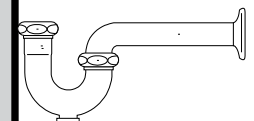

COMMERCIAL LINE

Part Num.	Item Description	UPC# 046224 +	Ctn Qty	Ctn Wt	Line Art
SEMI-CAST TRAPS WITH CLEANOUT - BRASS NUTS - CONTINUED					
5303PCDF	1 1/4" X 1 1/4" 17GA POLISHED CHROME - DEEP FLANGE	93264 2	25	38 lbs.	
5307PCDF	1 1/2" X 1 1/2" 17GA POLISHED CHROME - DEEP FLANGE	93270 3	25	58 lbs.	
5307XPC	1 1/2" X 1 1/2" 17GA POLISHED CHROME - GROUND JOINT	93273 4	25	58 lbs.	
5311XPC	1 1/4" X 1 1/2" 17GA POLISHED CHROME - GROUND JOINT	93279 6	25	59 lbs.	
SEMI-CAST TRAPS WITH CLEANOUT - DIE CAST NUTS					
5303PCDC	1 1/4" X 1 1/4" 17GA POLISHED CHROME	93262 8	25	44 lbs.	
5307PCDC	1 1/2" X 1 1/2" 17GA POLISHED CHROME	93268 0	25	58 lbs.	
5311PCDC	1 1/4" X 1 1/2" 17GA POLISHED CHROME	72533 6	25	60 lbs.	
CAST SWIVEL TRAP - BRASS NUTS					
5461XPC	1 1/2" X 1 1/2" POLISHED CHROME WITH CLEANOUT GROUND JOINT - IPS	93357 1	25	53 lbs.	
CAST BRASS LAVATORY GRID STRAINER					
5680PC	1 1/4" X 8" POLISHED CHROME WITH OPEN GRID STRAINER	70025 8	25	19 lbs.	
5681PC	1 1/4" x 8" POLISHED CHROME WITH OPEN GRID STRAINER (6" TAILPIECE)	93394 6	25	28 lbs.	
5682PC	1 1/4" x 1 1/2" X 6" POLISHED CHROME WITH OPEN GRID STRAINER	93396 0	25	19 lbs.	
CAST BRASS LAVATORY STRAINER FOR WHEEL CHAIR					
5700PC	1 1/4" POLISHED CHROME WITH STRAINER AND DRAIN ASSEMBLY - 17GA TAILPIECE FOR WHEELCHAIR	93400 4	25	38 lbs.	
LOOSE KEY STOPS - BRASS STEM - TAMPER PROOF					
7450PC	3/8" OD X 3/8" IPS ANGLE STOP - POLISHED CHROME	72596 1	25	2 lbs.	
7450KL12PC	3/8" OD X 1/2" LAVATORY SUPPLY KIT WITH 3/8" IPS ANGLE STOP X 12" SUPPLY TUBE AND FLANGES - POLISHED CHROME	70521 5	10	8 lbs.	
7451PC	3/8" OD X 1/2" NOM. INLET WITH 5" EXTENSION ANGLE STOP - POLISHED CHROME	70422 5	5	3 lbs.	
7451KL12PCDF	3/8" OD X 1/2" NOM. INLET X 12" LAVATORY KIT WITH 5" EXTENSION - ANGLE STOP - POLISHED CHROME	70517 8	10	8 lbs.	
7452PC	1/2" OD X 3/8" IPS - ANGLE STOP - POLISHED CHROME	70294 8	5	3 lbs.	
7453PC	3/8" OD X 1/2" IPS - ANGLE STOP - POLISHED CHROME	70423 2	5	3 lbs.	
7454PC	1/2" OD X 1/2" IPS - ANGLE STOP - POLISHED CHROME	70424 9	5	2 lbs.	
7400PC	KEY FOR LOOSE KEY STOPS	07400 7	5	4 lbs.	
URINAL STRAINER					
874PC	BEEHIVE URINAL STRAINER	71092 9	5	8 lbs.	